



minimalistic contemporary detail

Innovative Solutions for Contemporary Design & Architecture



Innovative Solutions – Increased Consistency and Reduced Labour

In Modern/Contemporary design minimalistic features are often incorporated into the design. We are building on the beauty of clean lines. ZIP-CLIK[®] are purpose built products to make the contractors job easier to achieve greater consistencies than often found in what are challenging details to construct.

Reveals

Where applicable ZIP-CLIK[®] is engineered to make it easier to create perfectly consistent reveals.

Labour Savings

Multiple processes in less steps or the ability to facilitate pre-finished products easier, equates to a savings on labour costs.

Quality Controls

Our pre-fabricated and knock-down systems built in-house mean greater quality control.

Easier Co-ordination of On-site Trades

Jamb systems, for example, are set into place after the drywall is installed. The benefits' are twofold; 1) Less tradespeople working around installed (finished) openings, 2) As job is further in the construction process when the installation occurs, enables contractor to turn on humidity control systems. This means that there will be a reduced likelihood of expansion and contraction in the doorway openings.

Lower Final Cost

ZIP-CLIK[®] offers a net cost advantage compared with traditional time-consuming methods!

The following pages outline the product description as well as some other products that we offer for use in contemporary construction. If Contemporary Architecture is your design choice for your next project specify ZIP-CLIK[®], now available at Forest View Industries Ltd.



“The details are not the details,
they make the design.”

– Charles Eames

Table of Contents

p 4-8	ZIP-CLIK [®] Jamb systems – The Original
p 9	ZIP-CLIK [®] Lyte
p 10	Our Mission Statement
p 11-12	ZIP-CLIK [®] Base
p 13	ZIP-CLIK [®] Pocket door kits
p 14	Other products we offer
p 15	Ultra Heavy Duty Doors with Anti-Warping Technology
p 16-20	ZIP-CLIK [®] Inspired Designs



ZIPCLIK

Included in each ZIP-CLIK® jamb assembly is the following:

- Pre-cut support and reveal trim PVC member that is pre-assembled to the back of a wood jamb.
- * FVI approved glue is applied between PVC support/reveal trim and wood jamb.
- * The PVC member is cut on miters at the head and wood jamb is cut square (except for rabbeted jambs which are specific to client needs and availability).
- The doorstop is pre-cut.
- The jamb system is pre-drilled at the head for quick assembly and wood screw.
- The hinges are pre-machined in the jambs and the doors.
- The doors are pre-machined for standard tubular latch mechanism (mortise body is extra) and the faceplate is pre-machined in the door.



If opportunity doesn't knock,
build a door.
- Milton Berle

Ask one of our
representatives
about our many
door options

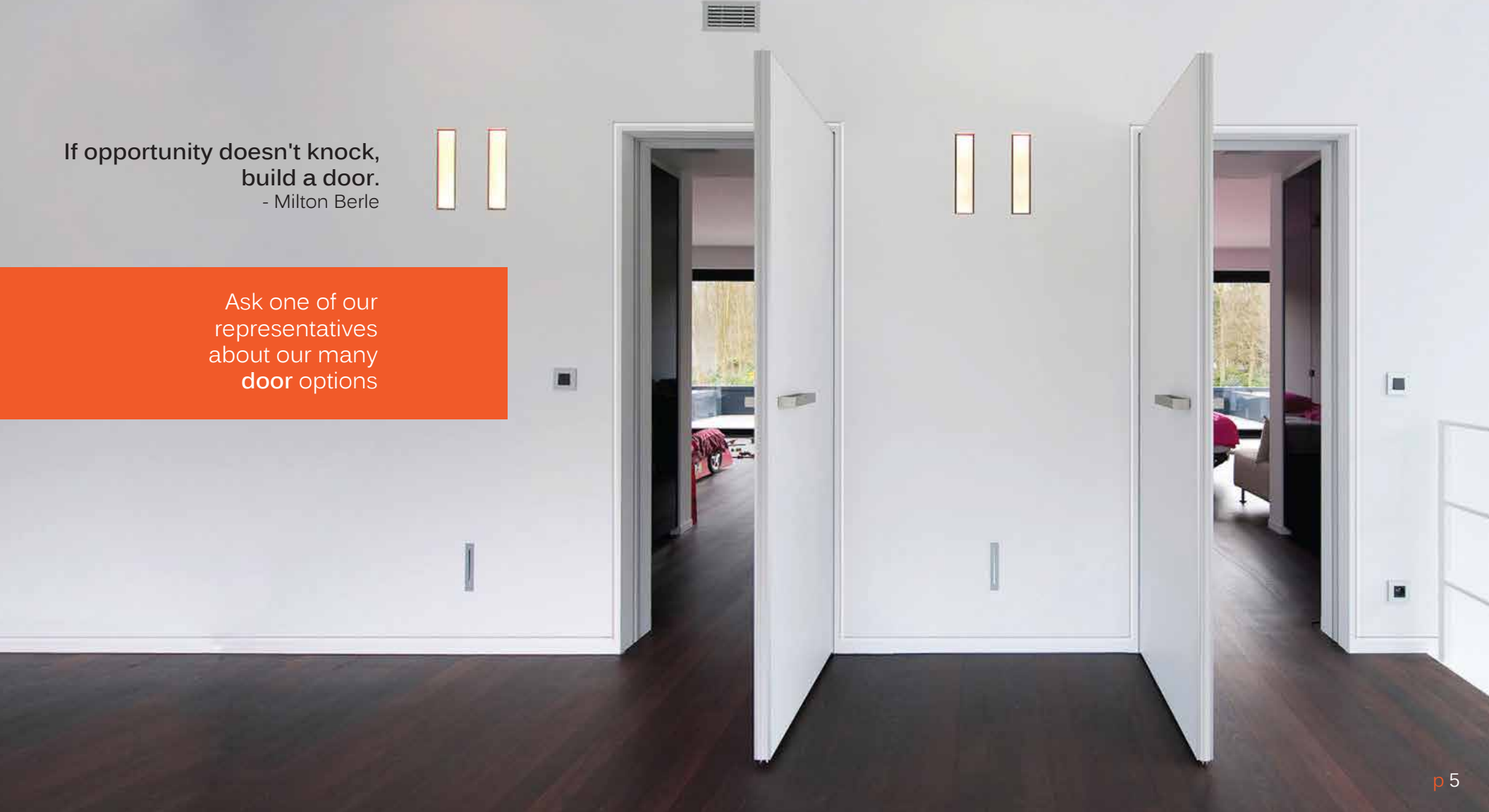

Easy Installation Steps:

1. Measure the length (height) of jamb required. Need to check the floor with a level and then determine what the length of jamb is required on each side. (If floor is uneven one side may be longer).

- Check amount required below the door and add to the jamb length.

2. Cut the jamb length to suit.

3. Pre-assemble jamb head. (Use pre-screwed holes). (See image #1)

4. Set into the opening. Assemble working from the head down.

- Use of clamps is recommended.

(See image #2)

5. Pre-Drill holes using 1/8" drill bit for shimless 3-1/8" screws which eliminate the need for shims. This can be hidden behind door stop.

(See image #3)

- These screws serve a double purpose: for shimming as well as for holding jamb.
- A Door or a spacer bar can be used to set width.
- It is easy to mark the amount of plumbing/shimming that is required. Simply mark a pencil line/reference point on the drywall and back the shimless screw out or draw it in as required to take the jamb to the desired point. (See image #4)
- A level and/or a straight edge can be used for plumbing.

6. Once set and plumbed in opening, the loose portion of the PVC 'reveal' trim can be placed in on the opposite side.

7. Nail through the PVC reveal trim tabs with drywall nails. Now you are ready for drywall compound.

- We recommend Durobond 90 for the base layer.





Calculating a rough opening width for ZIP-CLIK[®]:

A - Space between PVC and Stud	$0.1875 \times 2 = 0.375$
B - Thickness of PVC	$0.0625 \times 2 = 0.125$
C - Reveal	$0.50 \times 2 = 1"$
D - Jamb Thickness*	$0.75 \times 2 = 1\text{-}1/2"$
E - Margin Between Door and Jamb	$0.125 \times 2 = 0.250$

For Rough Opening Width Add 3-1/4" (82.6mm) to Door
 Add an Additional 0.0625" (1.6 mm) for Double Doors

*Many jamb thicknesses are available

Calculating a rough opening height AFF* for ZIP-CLIK®:

A - Space between PVC and Stud	$0.1875 \times 1 = 0.1875$
B - Thickness of PVC	$0.0625 \times 1 = 0.0625$
C - Reveal	$0.50 \times 1 = 0.50$
D - Jamb Thickness	$0.75 \times 1 = 0.75$
E - Margin Between Door and Jamb	$0.125 \times 1 = 0.125$
F - Distance Between Finished Floor and Door	$0.50 \times 1 = 0.50$

Total Rough Opening Height—2 1/8" (54mm) added to door height AFF*

*AFF (Above Finished Floor)

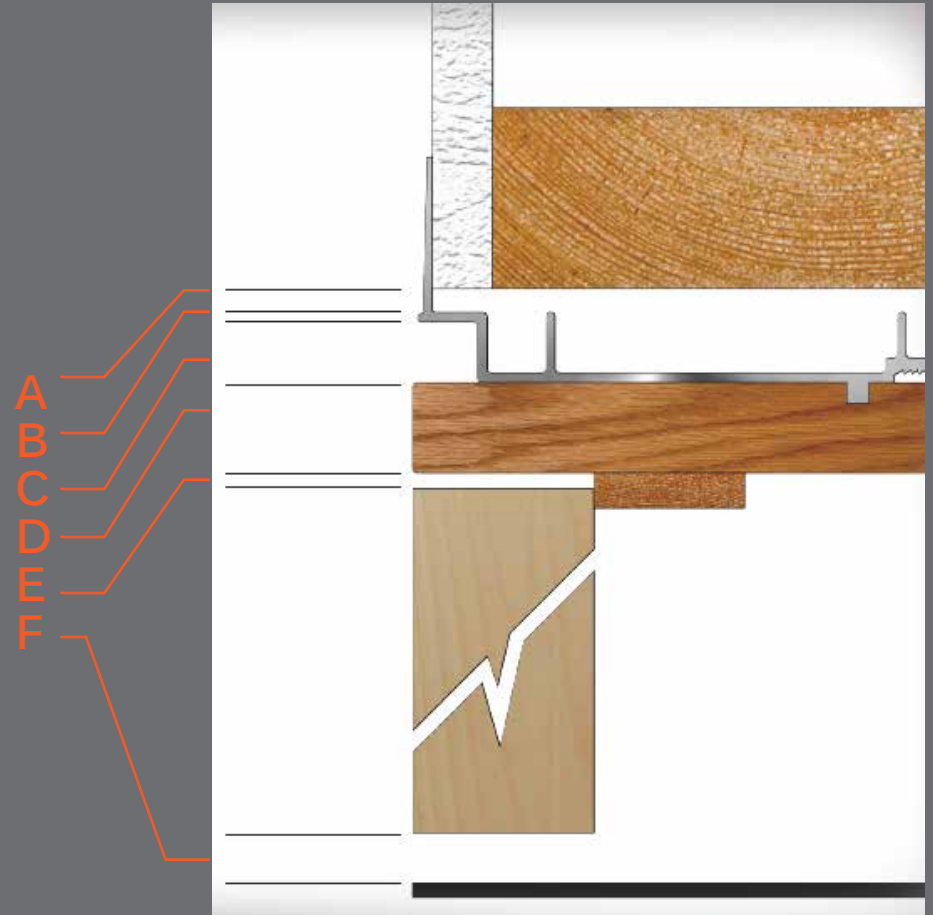

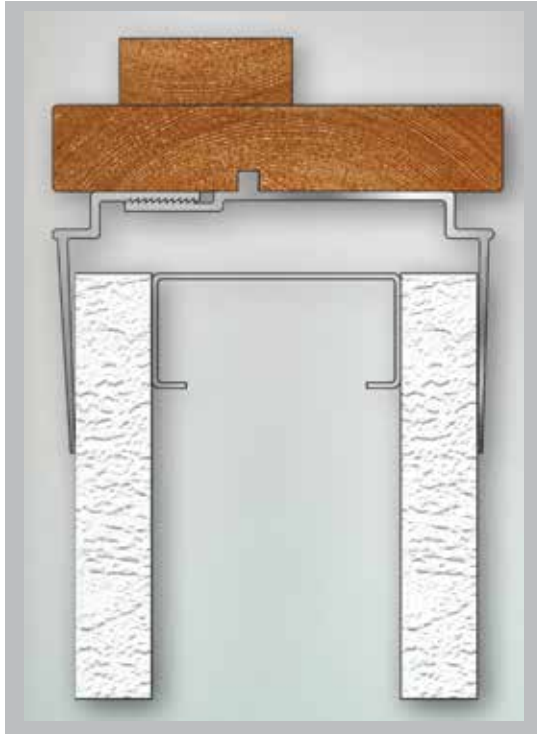

ZIP CLIK

Lyte

Our new ZIP-CLIK® LYTE jamb system for contemporary design is now being offered in a value engineered package. The initial launch will be project-specific. With reduced labour you can now use a reveal in your next project at a cost that has never before been attainable.





“Revolutionizing the way modern design accents are achieved.”

ZIP-CLIK® BASE AND FLOOR TRIMS

Armedo

The Armedo base is a system that has been developed in response to feedback from Architects, trades and people within the industry, to make the trades job easier to install a base that is flush with the wall and where there is a reveal or space between the base and drywall. The Armedo features:

Body Connector Assembly

- This feature clicks into the reverse side of the PVC body and makes it “a snap” to keep the top edge of the reveal a perfectly consistent, uninterrupted line.

Clips (Decorative Contact Portion)

- This feature enables the base to be installed with no fasteners through the face. It also enables installation of pre-finished baseboard reducing labour and making it easier to get a shop quality finish. An additional benefit is that the PVC portion of the reveal can have the finish coats of paint applied, before the base is installed, making the trades job of painting this small area easier.

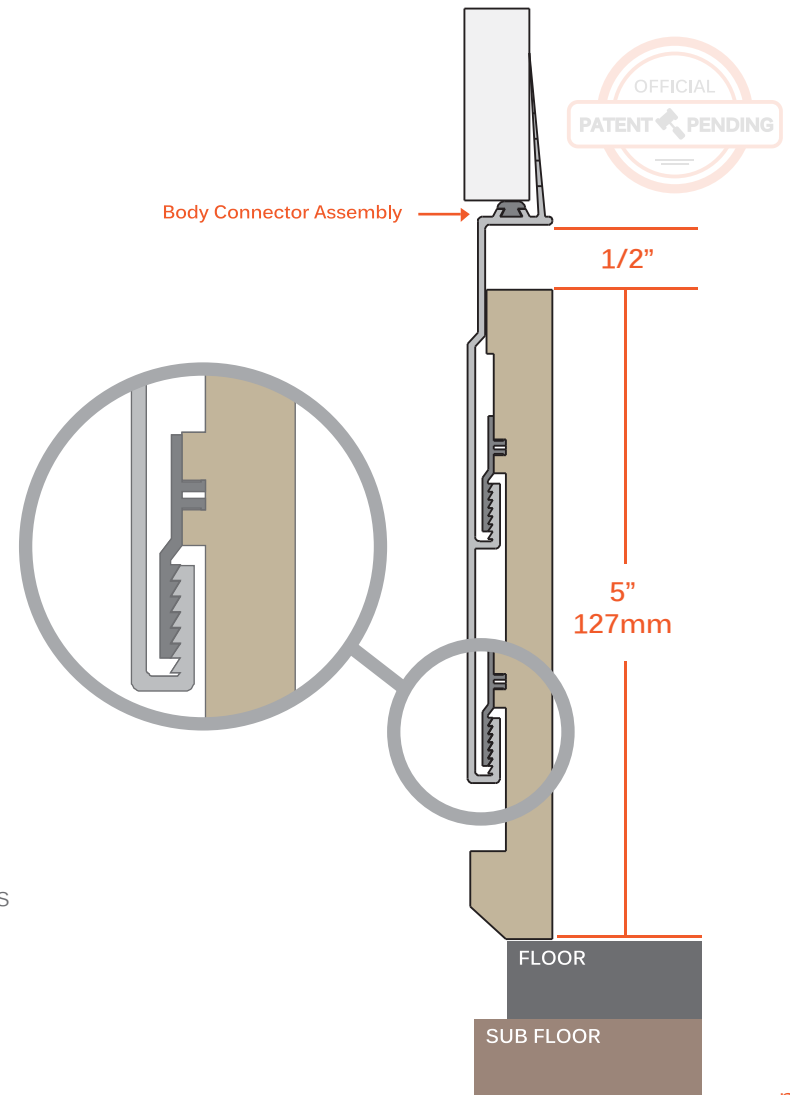

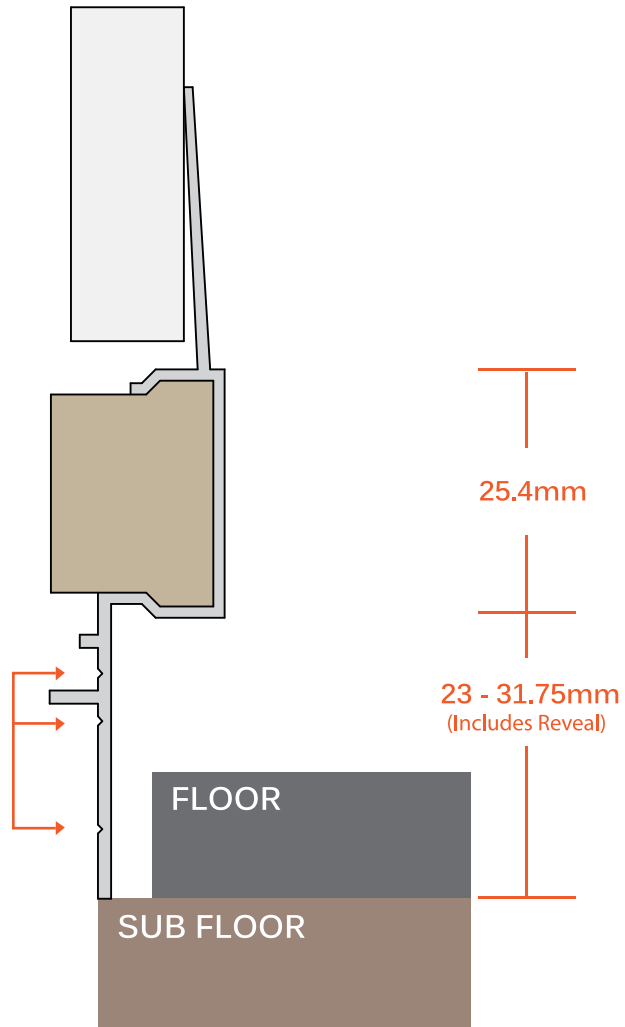

Tear Away Options

Tearaways are built into the profile to make it easy to remove to set at heights between 23 -31.75 mm from the sub-floor.

Bazik

This is a base system that is engineered for application where there is a reveal between the finish floor and the drywall.

The features of the product are as follows:

Protection member

- This will resist against damage caused by objects hitting the lower portion of the walls.

Base Extension with Tear-away

- This can be set on the sub-floor. The standard length extender allows for a 12mm (1/2") reveal when a 3/4" finish floor surface (distance from the sub-floor to the top of the finish floor) is chosen. The tearaway will allow for a 6mm reveal with the extension still touching the sub-floor. Where the sub-floor is uneven the extension can be removed and the top edge of the reveal can be set using a laser line.

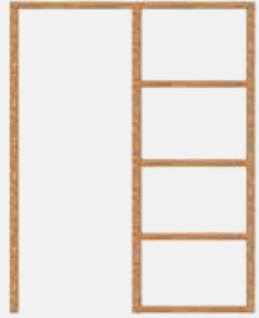

We can build to most custom drawings or provide a shop drawing for your details.

PRE-ASSEMBLED POCKET DOOR KITS

Pre-built pocket door kits with heavy duty track and hardware are now available for quick installation. These kits dramatically reduces on-site labour to build, are very heavy duty and are also customizable in terms of opening width and height.

Simply determine the door size, advise us of the wall width that it is fitting into and we will supply a pre-fabricated unit that is ready for assembly and fast site installation.

Another benefit is the ease in which the unit is squared and shimmed making plumbing the door with the track and ends that much easier. The wood jamb is installed on site.



Head for Pocket Doors using ZC-Pocket Door Track and Hardware

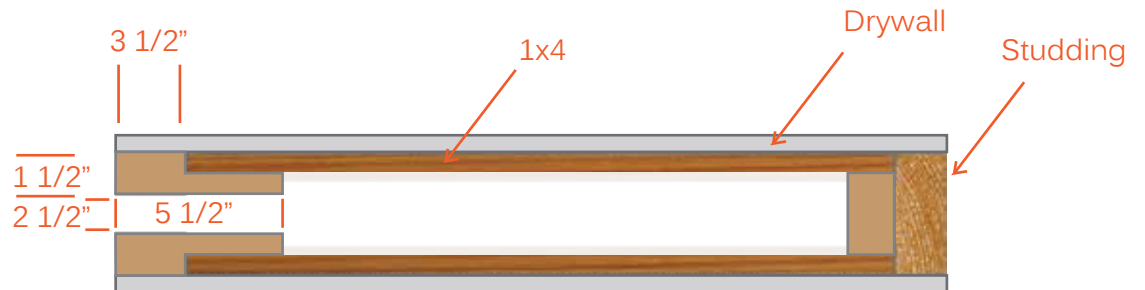



[other products we offer]

8500-ME (5 PLY)

PARTICLE CORE, ULTRA HEAVY-DUTY,
ANTI-WARPING CONSTRUCTION FOR
INTENSIVE USE.

LOCK BLOCK: Integrated.

GLUE: Type 1 PVA Cross-link (NAUF).

INTERIOR USE

WARRANTY: LIFETIME

OPTIONS

20 minute fire rating, specify 8520-ME, 8520-ME NAUF/FSC or 8520-ME-AF Wood veneer glued to plywood veneer (3 ply plywood) (7ply door). Autonomy door available, specify 8513-ME, 8513-ME NAUF/FSC or 8513-ME-AF.

* To get M.R. 6.0, specify agrifibre core (8500-ME-AF).

** To get M.R. 7.0: Option 1: specify particleboard core NAUF/FSC (8500-ME NAUF/FSC) and FSC faces to optimize.

Option 2: specify agrifibre core (8500-ME-AF) and FSC faces, only when M.R. 6.0 is also required.

*** To get I.E.Q. 4.4, specify particleboard core NAUF/FSC (8500-ME NAUF/FSC) or agrifibre core (8500-ME-AF) and NAUF or NAUF/FSC faces.

NOTE: Dimensions are nominal before trimming.

1. STILES: 1/8" (3 mm) thick veneer, longitudinally laminated by hot pressing with type 1 structural glue, as per ASTM-D5456-93 (LVL FSC), including a 7/8" (22 mm) piece of hardwood, matched with faces, for a total width of 4 3/16" (107 mm).

2. TOP AND BOTTOM RAILS: 1/8" (3 mm) thick veneer, longitudinally laminated by hot pressing with type 1 structural glue, as per ASTM-D5456-93 (LVL FSC), or laminated strand lumber (LSO for a total width of 3 5/16" (85 mm).

3. CORE: Solid particleboard. Density of 28-32 lbs per cubic foot. Complies with CSA-0188 and ANSI A208-1 standards (LD-1/LD-2). Available AUF/FSC (LD-2).

4. FACES: Wood veneer (choice of face veneers; 2 ply plywood), hardboard panel or plastic laminate glued to composite crossband. Available NAUF/FSC.

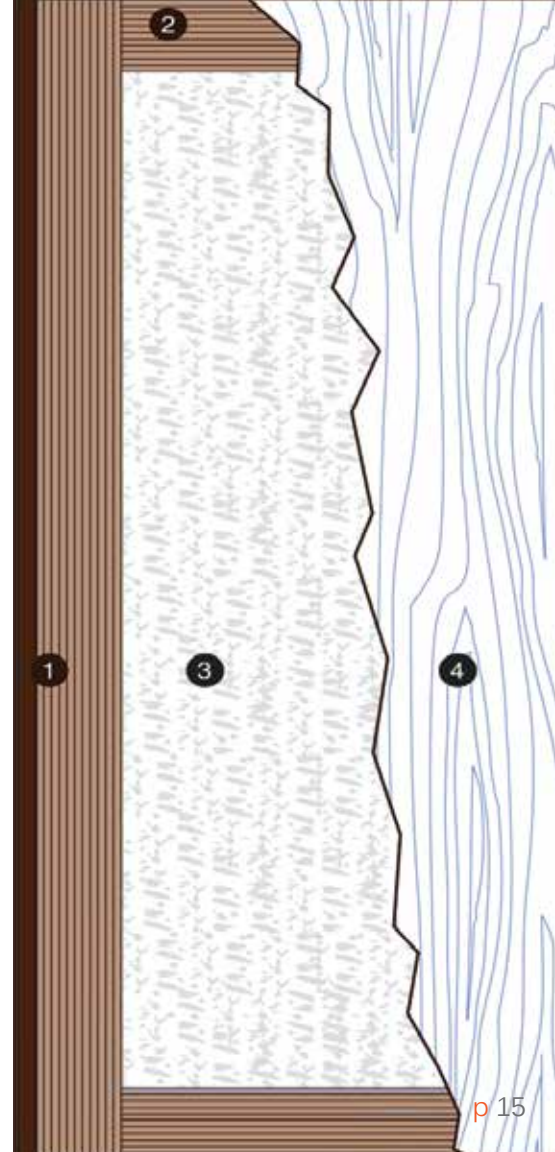

[inspired designs]













Forest View Industries Ltd. - Authorized distributor of ZIP-CLIK®
Toll Free: 1-888-293-5913
Tel: (905) 272-2515
E-mail: sales@forestviewindustries.com

1756 Mattawa Avenue
Mississauga, ON L4X 1K1

ZCMK-00315