



minimalistic contemporary detail

Jamb and Baseboard Reveal Systems • Pocket Door Kits



Welcome To The ZIP-CLIK[®] System

In Modern/Contemporary design minimalistic features are often incorporated into the design. We are building on the beauty of clean lines. ZIP-CLIK[®] are purpose built products to make the contractors job easier to achieve greater consistencies than often found in what are challenging details to construct.

Reveals

Where applicable ZIP-CLIK[®] is engineered to make it easier to create perfectly consistent reveals.

Labour Savings

Multiple processes in less steps or the ability to facilitate pre-finished products easier, equates to a savings on labour costs.

Quality Controls

Quality Control is easier with ZIP-CLIK[®] products. Our available 'knock-down' kits offer excellent yield with reduced tendency for waste. The flange on our reveal trims are wider than most reveal products currently on the market, which provide a greater tolerance.

Easier Co-ordination of On-site Trades

Jamb systems, for example, are set into place after the drywall is installed. The benefits' are twofold; 1) Less tradespeople working around installed (finished) openings, 2) As job is further in the construction process when doors and jambs are installed, this equates to the site conditions being that much closer to having humidity controls in place when this occurs. This equates to a more stable environment which means reduced potential for expansion and contraction in the doors and openings.

Lower Final Cost

ZIP-CLIK[®] offers a net cost advantage compared with traditional time-consuming methods!

The following pages outline the product description as well as some other products that we offer for use in contemporary construction. If Contemporary Architecture is your design choice for your next project specify ZIP-CLIK[®], now available at Forest View Industries Ltd.

Table of Contents

p 1	Introduction
p 4-11	ZIP-CLIK [®] Jamb System
p 12-16	ZIP-CLIK [®] Baseboard Options
p 17-20	Installation Instructions and Technical Details
p 21-25	Other Products We Offer
p 26-30	ZIP-CLIK [®] Inspired Designs

If opportunity doesn't knock,
build a door.
- Milton Berle

Ask one of our
representatives
about our many
door options

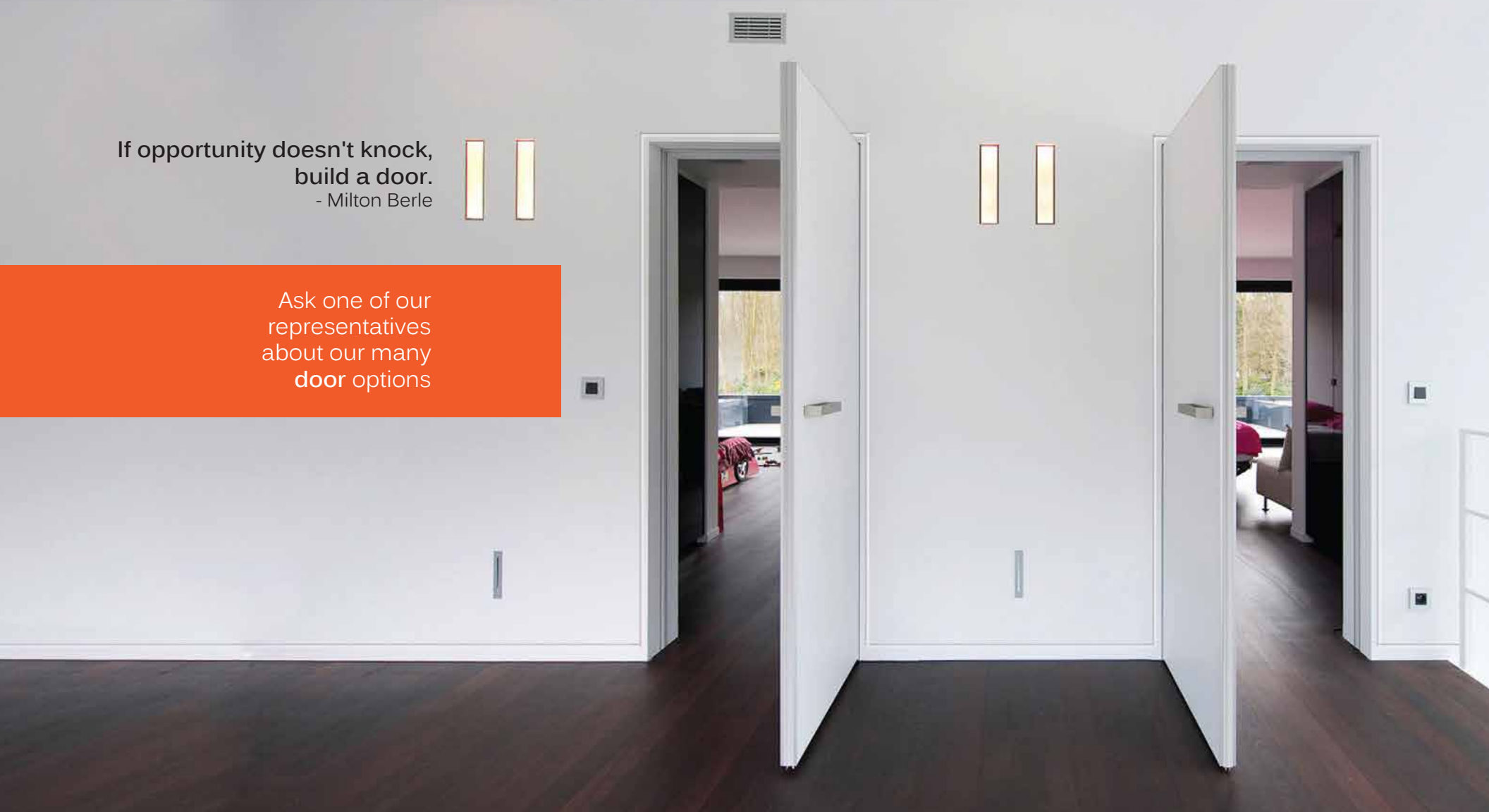

ZIP CLIK

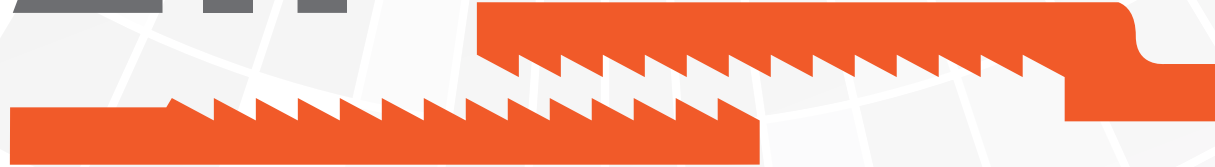

The ZIP-CLIK® Series have the overall goal of providing a consistent reveal in your architectural designs. The system is designed to simplify the process of installing a jamb with reveals. ZIP-CLIK® products are high quality and suited for high end projects. They are engineered with the following key benefits; reduced onsite labour, improved consistency, improved sequencing of installation process and are available to order as outlined on the following pages.

American Poplar jambs available as shown for paint grade application.

Custom jambs and exotic species jambs are available by special order.

The ZIP-CLIK® Jamb Systems

The ZIP-CLIK® **Select Series Jamb System** is engineered to make it easier to create reveals for contemporary design after drywall is installed. The ZIP-CLIK® Select Series has a 'receiver' that is mounted into the back of a wood jamb. This 'receiver' creates a friction fit for the drywall reveal trim once the reveal trim is inserted into the opening.

The key benefits to the ZIP-CLIK® Select Series Jamb systems are 1) a consistent reveal, 2) a more conventional installation when compared with our ZIP-CLIK® Ultra Series Jamb system and 3) being able to create reveals and set the jambs after drywall. The ZIP-CLIK® Select Series is also available as loose components.

SKU

DESCRIPTION

ZCSS14RVL

ZIP-CLIK® Select Series 1/4" PVC Reveal Trim

ZCSS12RVL

ZIP-CLIK® Select Series 1/2" PVC Reveal Trim

ZCSSRecPrw/TO

ZIP-CLIK® Select Series PVC Receiver Portion for 2 x 6 walls,
with tear off for 2 x 4 walls

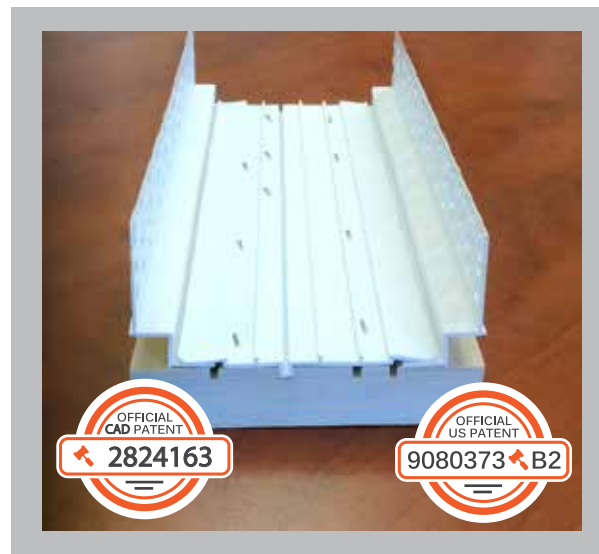



The ZIP-CLIK[®] Jamb System

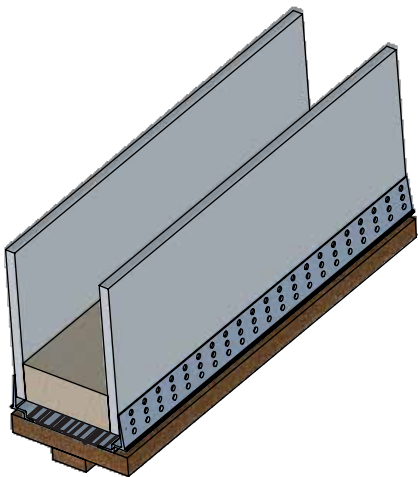

Dressed Jamb

Dressed Four Sides (D4S) 3/4" Thick Jambs

- D4S 3/4" X 4-7/8" (For 2 X 4 Walls with 1/2" Drywall)
- D4S 3/4" X 6-7/8" (For 2 X 6 Walls with 1/2" Drywall)

- Other jamb widths are available by special order

Available in 1/4" and 1/2" Reveals

See Dressed Jamb Section

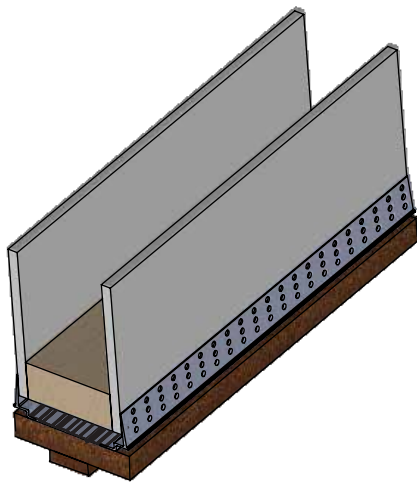

Square Jamb

1" thick jamb with 4 Eased Edges

- 1" X 4-7/8" (For 2 X 4 Walls with 1/2" Drywall)
- 1" X 6-7/8" (For 2 X 6 Walls with 1/2" Drywall)

- Other jamb widths are available by special order

Available in 1/4" and 1/2" Reveals

See Square Jamb Section

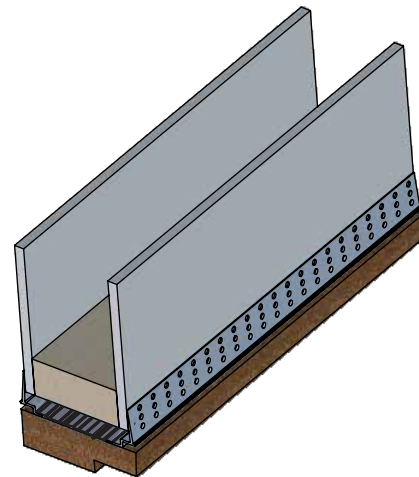

Rabbetted Jamb

1-1/2" Rabbetted Jambs

- 1-1/2" X 4-7/8" (For 2 X 4 Walls with 1/2" Drywall)
- 1-1/2" X 6-7/8" (For 2 X 6 Walls with 1/2" Drywall)

- Other jamb widths are available by special order

Available in 1/4" and 1/2" Reveals

See Rabbetted Jamb Section

Dressed Jamb - 3/4" Thick Dressed Four Sides Jambs (Cross-Section Drawings)



1/2" X 1-5/8" DOORSTOP

SKU

ZCSSAPD4S34-478

ZCSSAPD4S34-678

D1.2X15.8AP

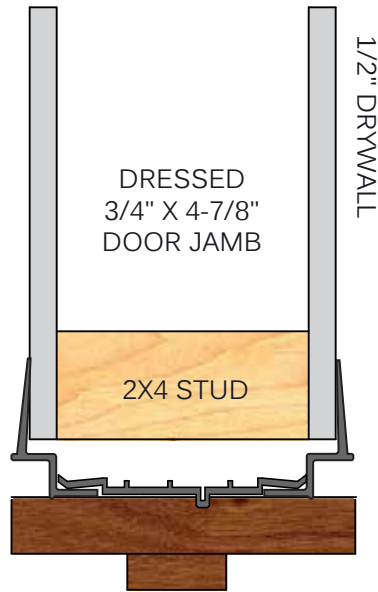

1/2" X 1-5/8" DOORSTOP

DESCRIPTION

ZIP-CLIK® Select Series Wood Jamb D4S 3/4" x 4 7/8" American Poplar (Comes Pre-grooved)

ZIP-CLIK® Select Series Wood Jamb D4S 3/4" x 6 7/8" American Poplar (Comes Pre-grooved)

ZIP-CLIK® Select Series Wood Doorstop D4S 1/2" x 1 5/8" American Poplar

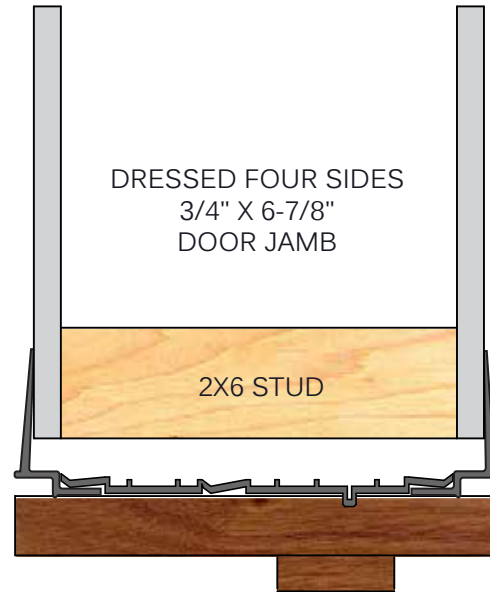

1/2" X 1-5/8" DOORSTOP

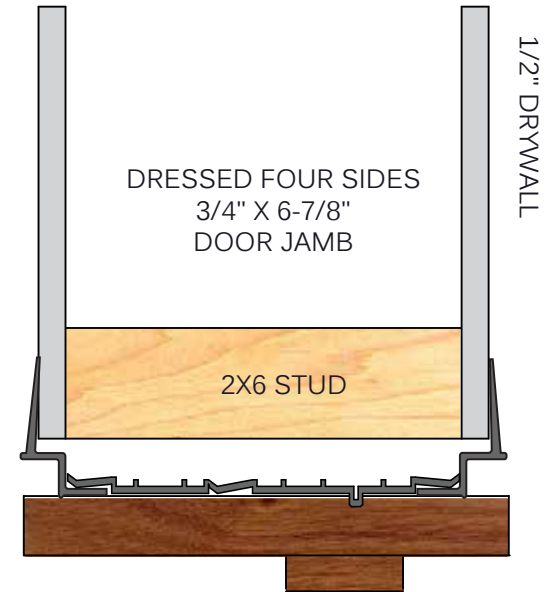

1/2" X 1-5/8" DOORSTOP

Square Jamb - 1" Thick Square Jamb with Eased Edges (Cross –Section Drawings)

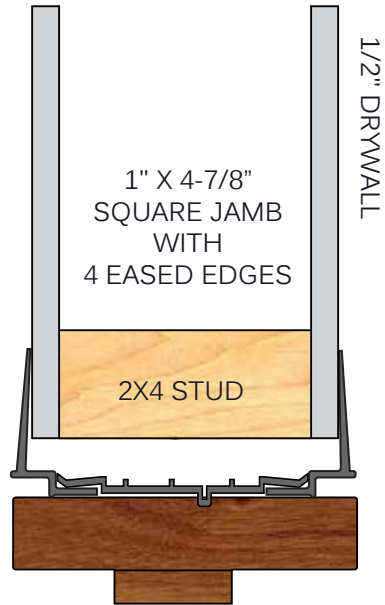

1/2" X 1-5/8" DOORSTOP

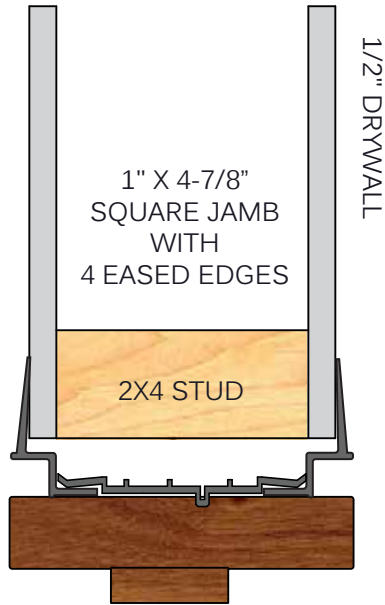

1/2" X 1-5/8" DOORSTOP

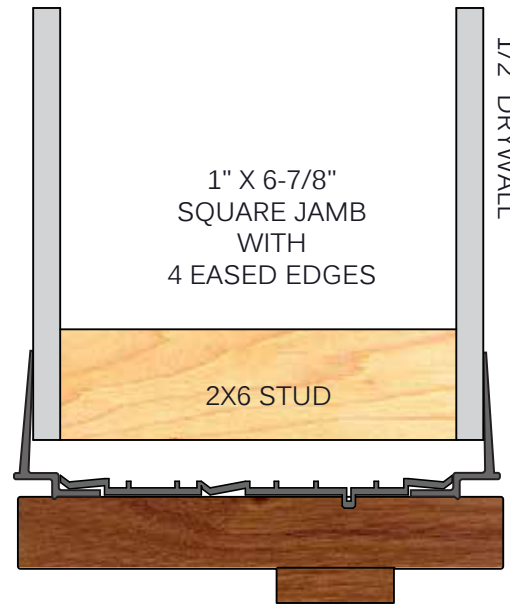

1/2" X 1-5/8" DOORSTOP

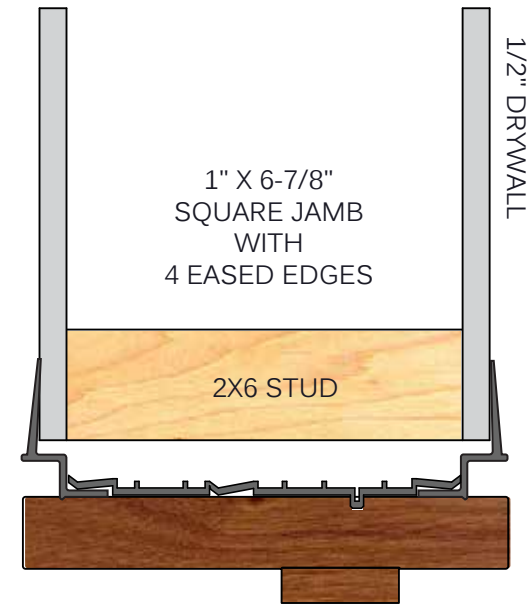

1/2" X 1-5/8" DOORSTOP

SKU

ZCSSAPSJ1-4784EE

ZCSSAPSJ1-6784EE

8 D1.2X15.8AP

DESCRIPTION

ZIP-CLIK® Select Series Wood Square Jamb 1" x 4 7/8" American Poplar with 4 Eased Edges (Comes Pre-Grooved)

ZIP-CLIK® Select Series Wood Square Jamb 1" x 6 7/8" American Poplar with 4 Eased Edges (Comes Pre-Grooved)

ZIP-CLIK® Select Series Wood Doorstop D4S 1/2" x 1 5/8" American Poplar.

Rabbetted Jamb - 1-1/2" Thick Rabbetted Jambs (Cross-Section Drawings)

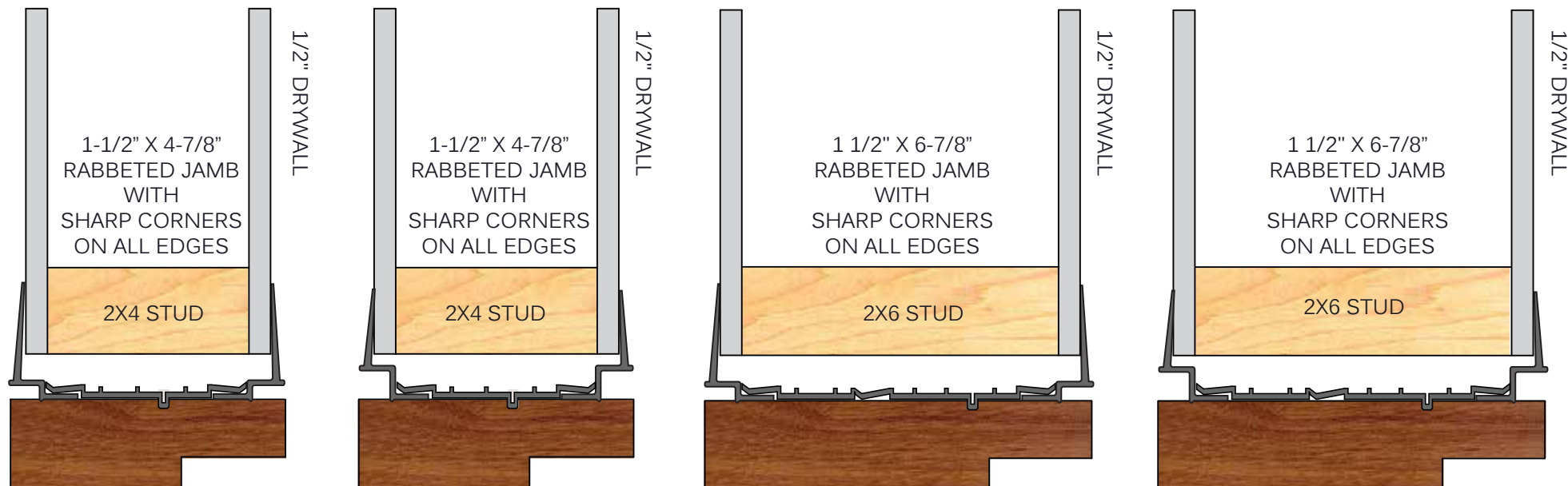

SKU

ZCSSAPRabJ112-478

ZCSSAPRabJ112-678

DESCRIPTION

ZIP-CLIK® Select Series Wood Rabbetted Jamb 1 1/2" x 4 7/8" American Poplar (Comes Pre-Grooved)

ZIP-CLIK® Select Series Wood Rabbetted Jamb 1 1/2" x 6 7/8" American Poplar (Comes Pre-Grooved)

A photograph of a modern, two-story house with a large glass facade and a wooden exterior. The house is illuminated from within, showing a bright interior. A swimming pool is in the foreground, reflecting the house and the sky. The sky is a deep blue, suggesting dusk or dawn. The text "Revolutionizing the way modern design accents are achieved." is overlaid in white, bold, sans-serif font. There are decorative elements: a row of white squares in the top left corner, a small tree in the background, and a small yellow and blue square in the bottom right corner.

“Revolutionizing the
way modern design
accents are achieved.”

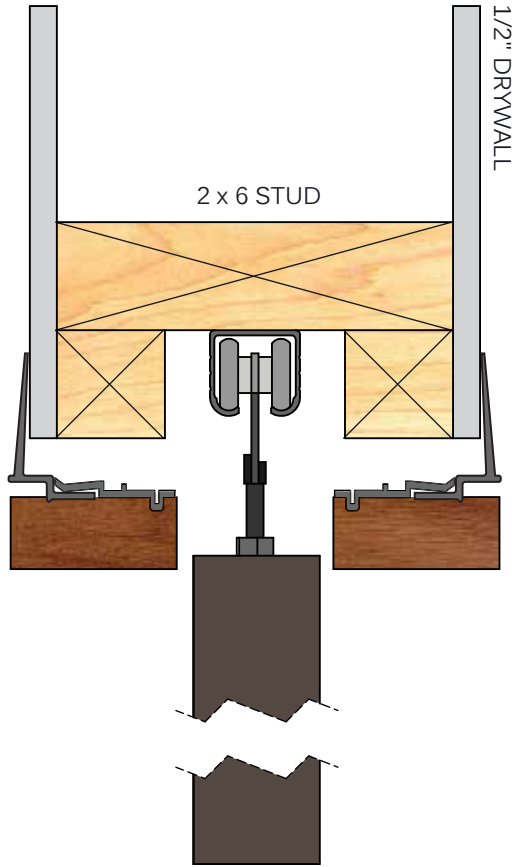

Suggested Cross-Section Drawings

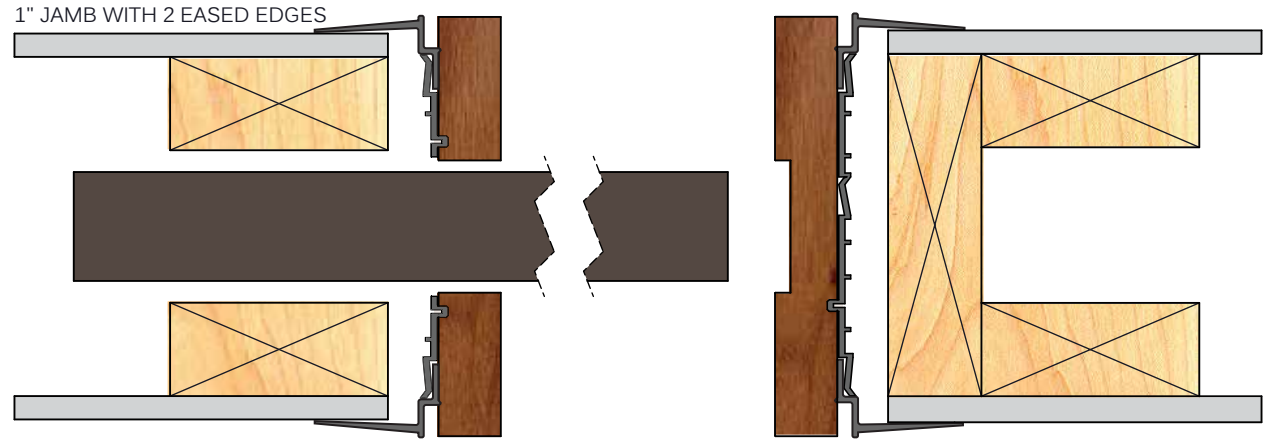

ZIP-CLIK® Jamb System for pocket doors

We offer ZIP-CLIK® jambs for pocket door applications. Shown with 1/2" Reveal -1/4" is also available. This is our suggested system that can be built to suit many wall thicknesses.

The 1" square jamb can be also used in applications where a 1-1/2" rabbetted jamb is used for swing door applications.

We offer a pre-grooved jamb for the fixed side of the opening as shown. The product number for this fixed side is ZCAPJFSPkDr1678.



ZIP-CLIK® BASE AND FLOOR TRIMS



Armado 3.1

The Armado baseboard system has been developed in response to feedback from Architects', Tradespeople and others within the industry, to make the trades job easier to install a base that is flush with the wall and where there is a reveal or space between the base and the drywall. The key benefits of the ZIP-CLIK® Armado Baseboard system are threefold:

Enables a more conventional installation sequence

- i) Drywall installed
- ii) PVC Main body installed
- iii) Mudding/drywall compound applied
- iv) Flooring installed
- v) Wood base portion scribed to the finish floor

Onsite labour

- i) More robust profile makes for an easier installation'

More consistent reveal with sharper lines

- i) Large area of PVC makes it easier to keep the nib or the finish edge of the drywall, straighter.

Armedo 3.1

The name Armedo comes from two key benefits of the system; one is Strength hence the first part Arm, and the other is Torpedo for straightness or 'edo' creating the name Armedo.

Another benefit of the Armedo base system is that when installed in conjunction with either of our jamb systems, makes for a cohesive jamb and base system.

The Armedo features:

Body Connector Assembly

- This feature clicks into the reverse side of the PVC body and makes it “a snap” to keep the top edge of the reveal a perfectly consistent, uninterrupted line.

Clips (Decorative Contact Portion)

- The clips mounted onto the back of the baseboard do not have teeth. Now, Armedo 3.1 has had the teeth on the main body of PVC removed from the Armedo 2.0. This allows for greater tolerance and an easier installation. This area now comes with protective film pre-applied, saving labour and reducing potential for dust particles to become embedded in this area.

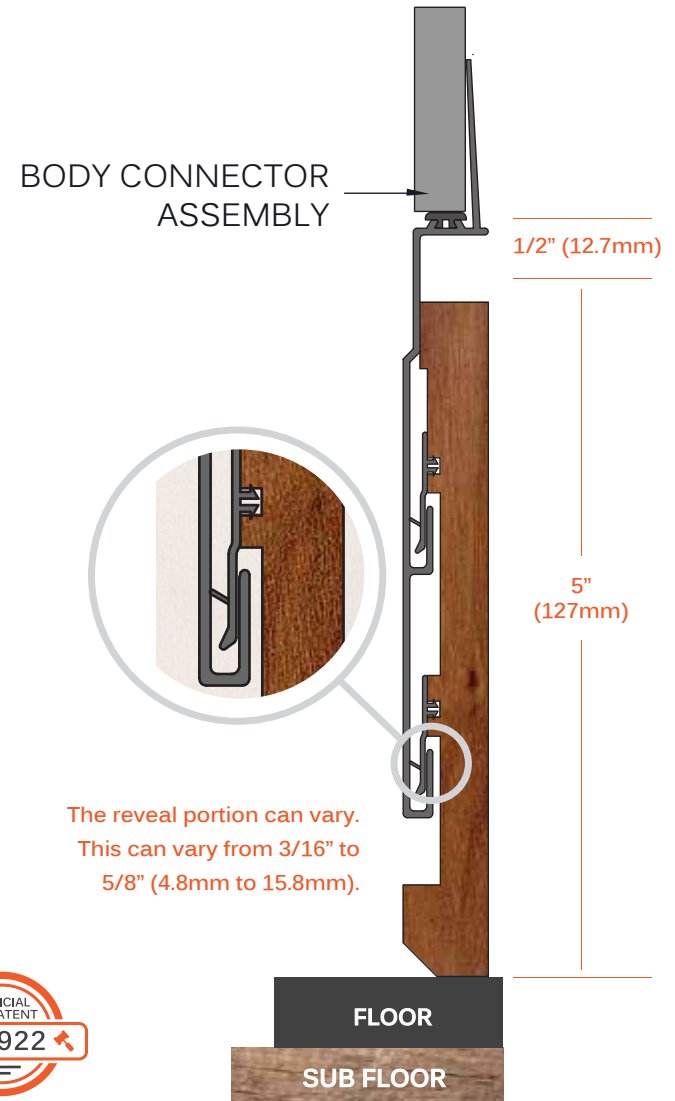



Bazik

The key benefit of the ZIP-CLIK® Bazik system is to provide a robust bottom edge of the drywall where a shadow line or reveal between the floor and the drywall is desired. The wood moulding inserted into the PVC profile is always touching the stud wall creating high resilience to this edge getting smashed or damaged where normal conditions may do so with most other drywall trims on the market.

The key benefits of the ZIP-CLIK® Bazik Baseboard system are threefold:

Enables a more conventional installation sequence

- i) Install drywall and set to desired height
- ii) Install finish floor
- iii) Install Bazik with desired reveal after floor is installed to best achieve a consistent reveal
- iv) Apply drywall compound, smooth and then paint with wall with selected colour

Onsite labour

- i) More robust profile makes for an easier installation'

More consistent reveal with sharper lines

- i) Ability to overlap the PVC over the wood when making connections during installation making it easier to keep the nib inline.

Bazik

This is a base system that is engineered for application where there is a reveal between the finish floor and the drywall.

The features of the product are as follows:

Protection member

- This will resist against damage caused by objects hitting the lower portion of the walls.

Base Extension with Tear-away

- This can be set on the sub-floor. The standard length extender allows for a 12mm (1/2") reveal when a 3/4" finish floor surface (distance from the sub-floor to the top of the finish floor) is chosen.

The tearaway will allow for a 6mm reveal with the extension still touching the sub-floor. Where the sub-floor is uneven the extension can be removed and the top edge of the reveal can be set using a laser line.

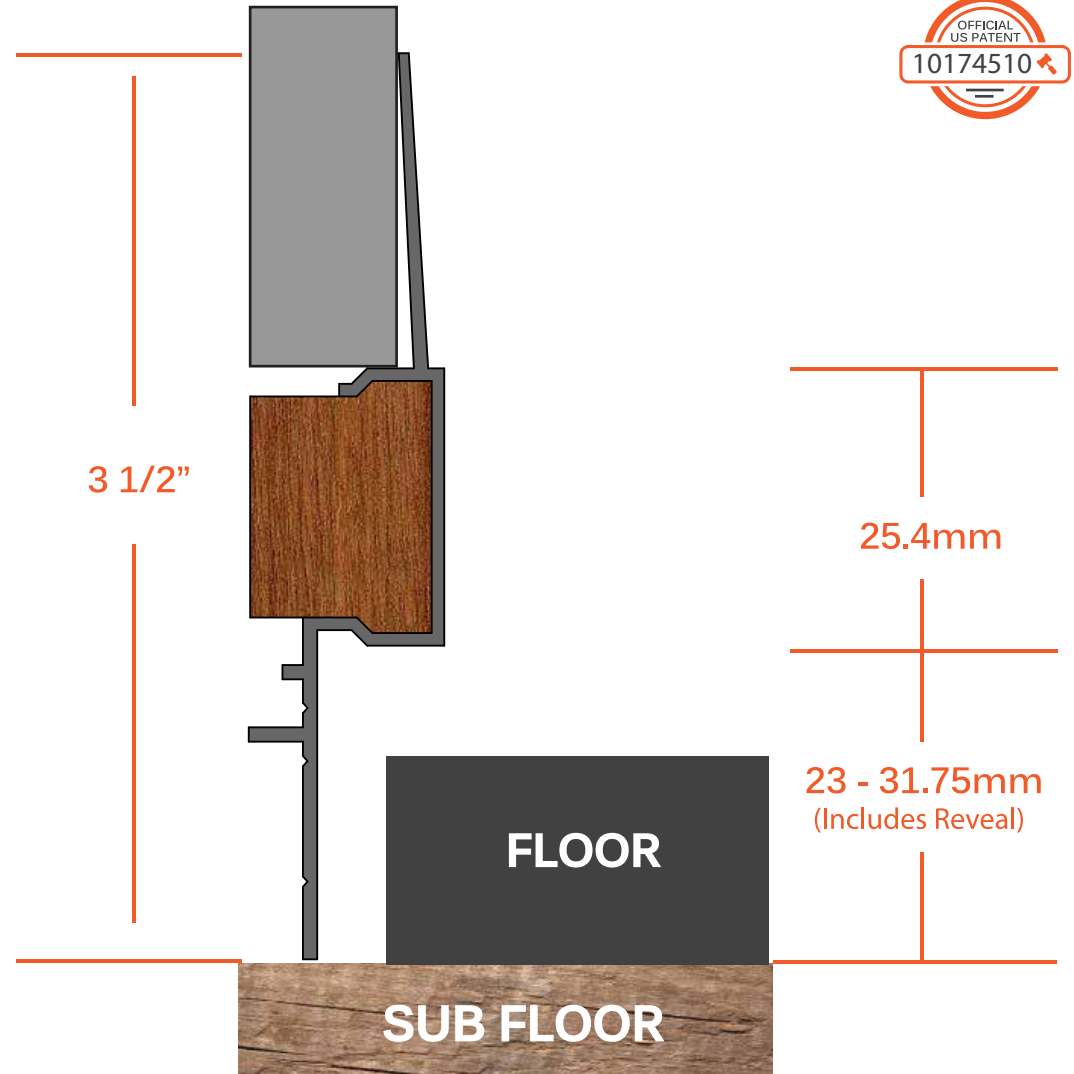

The background of the image is a solid orange color with a white line-art pattern of a circuit board. The pattern includes various traces, pads, and component footprints, creating a technical and electronic aesthetic.

ZIP-CLIK[®] Jamb System Technical Details

Easy Installation Steps:

Watch the online instructional video: www.youtube.com/watch?v=OVMWIW_Osf0 or www.forestviewindustries.com/zip-clip/

Installation Instructions for Swing Door

- Prepare jamb by setting receiver (if not ordered pre-installed), onto the back of the jamb.
- Cut, machine and set jambs as you would with a conventional jamb.
 - ** We suggest Shimming jamb 3/4" from stud wall assembly. This will allow reveal to go into place unimpeded by studs.
- Cut shims back to the receiver using a Dremel or multi-tool.
- Cut and set reveal trim into place.
 - **You can staple or screw through flange area.
 - **Contact cement can also be applied to wall area before setting reveal trim into place.
- Apply drywall compound to flange area and smooth.
 - ** We suggest mesh tape half on flange area before applying drywall compound
 - ** We recommend Durobond 90 or comparable product for base layer

Now your jamb opening is ready for paint

Installation Instructions for Pocket Door

The side of the opening that the door goes into is referred to as the 'Cavity' here and the side that the door closes against is the 'Fixed' side.

- Prepare jamb by setting receiver (if not ordered pre-installed), onto the back of the jamb on 'Fixed Side' of opening (if a single door).
- Cut Jambs and drywall reveal trims.
- Prepare opening for installation. We suggest pre-mounting reveal trims onto the back of the jamb for the cavity side of the opening and head.
 - ** Mount shims or spacers directly onto the framing, to square up opening on cavity side and head.
 - ** Mount reveal trims onto the back of the vertical jamb (cavity side) and horizontal components.
- Mount receiver onto back of jamb (if it does not come pre-installed), that will be installed on the fixed side of the opening.

- Assemble jamb and set into opening.
- Shim fixed side of opening as required.
- Install reveal trims onto fixed side of opening.

**You can staple or screw through flange area.

**Contact cement can also be applied to wall area before setting reveal trim into place.

- Apply drywall compound to flange area and smooth.

** We suggest mesh tape half on flange area before applying drywall compound

** We recommend Durobond 90 or comparable product for base layer

Now your jamb opening is ready for paint



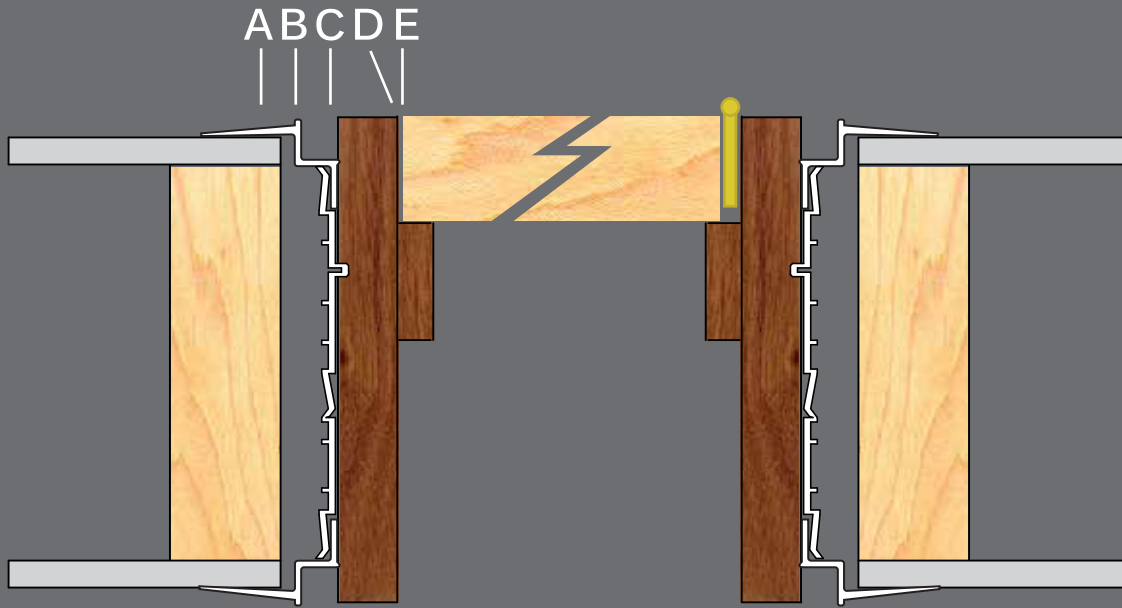

Calculating a rough opening width for ZIP-CLIK® Using 3/4\" Jamb:

A - Space between PVC and Stud	$0.25 \times 2 = 0.5$
B - Thickness of PVC	$0.0625 \times 2 = 0.125$
C - Reveal	$0.50 \times 2 = 1"$
D - Jamb Thickness*	$0.75 \times 2 = 1\text{-}1/2"$
E - Margin Between Door and Jamb	$0.125 \times 2 = 0.250$

For Rough Opening Width Add 3-3/8" (85.7mm) to Door
Add an Additional 0.0625" (1.6 mm) for Double Doors

*Many jamb thicknesses are available

Calculating a rough opening height AFF* for ZIP-CLIK® Using 3/4" Jamb:

A - Space between PVC and Stud	$0.25 \times 1 = 0.25$
B - Thickness of PVC	$0.0625 \times 1 = 0.0625$
C - Reveal	$0.50 \times 1 = 0.50$
D - Jamb Thickness	$0.75 \times 1 = 0.75$
E - Margin Between Door and Jamb	$0.125 \times 1 = 0.125$
F - Distance Between Finished Floor and Door	$0.50 \times 1 = 0.50$

Total Rough Opening Height—2 3/16" (55.6mm) added to door height AFF*

*AFF (Above Finished Floor)

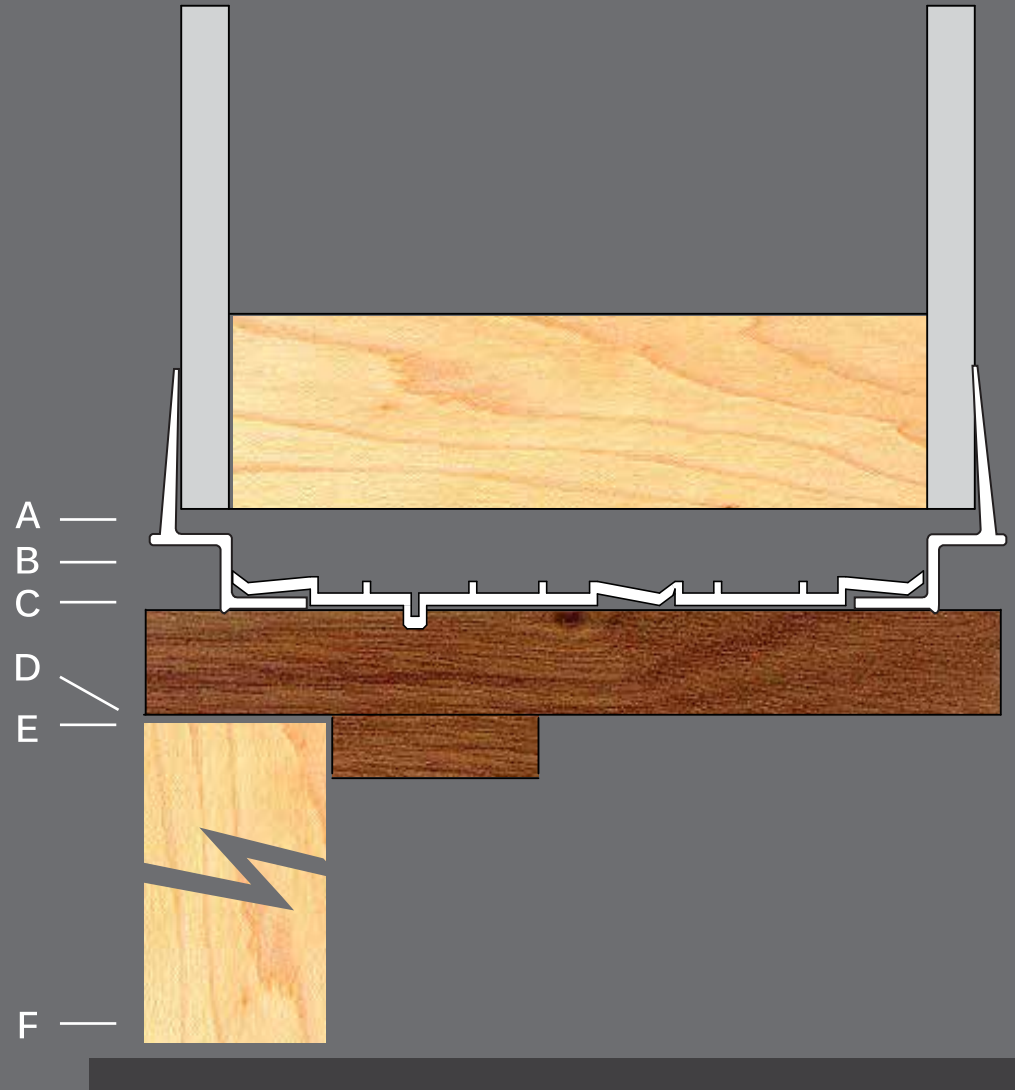



[other products we offer]

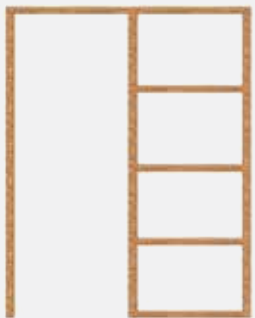

We can build to most custom drawings or provide a shop drawing for your details.



Head for Pocket Doors using ZC-Pocket Door Track and Hardware

PRE-ASSEMBLED POCKET DOOR KITS

Pre-built pocket door kits with heavy duty track and hardware are now available for quick installation. These kits dramatically reduces on-site labour to build, are very heavy duty and are also customizable in terms of opening width and height.

Simply determine the door size, advise us of the wall width that it is fitting into and we will supply a pre-fabricated unit that is ready for assembly and fast site installation.

Another benefit is the ease in which the unit is squared and shimmed making plumbing the door with the track and ends that much easier. The wood jamb is installed on site.

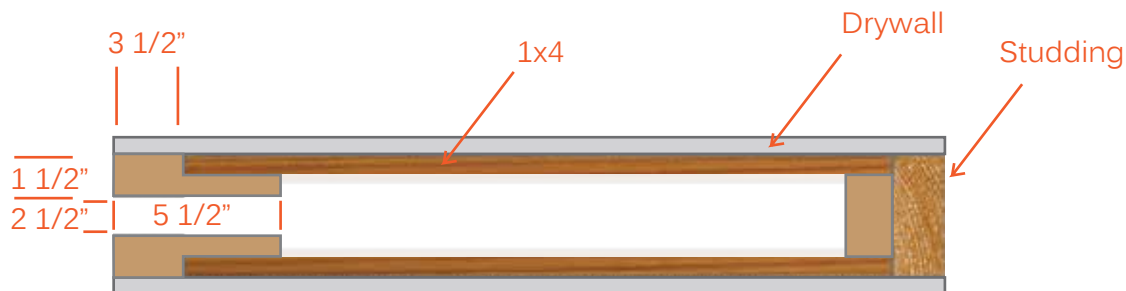



“The details are not the details,
they make the design.”

– Charles Eames

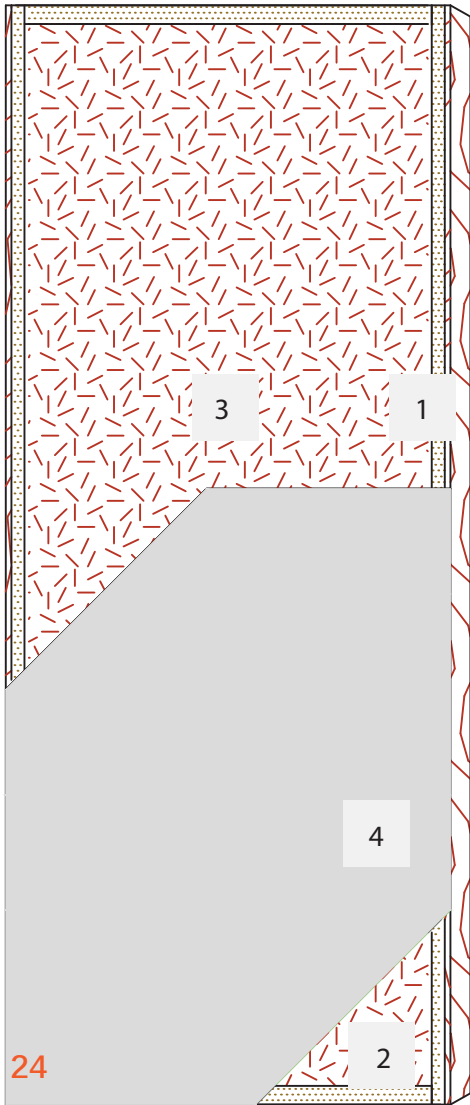

7-PC-CE (7 PLY)

PARTICLE CORE - INTERIOR USE

LOCK BLOCK: Integrated.

GLUE: Type 1 PVA Cross-link (NAUF).

INTERIOR USE

WARRANTY: LIFETIME

OPTIONS

LD-2 core.[Door1-3/4"- (44mm)
20 minute rating neutral or positive pressure.
15/16" (24 mm) wood (mill option) laminated to 1" (25
mm) structural composite lumber (SCL).
Bifold.

ARCHITECTURAL WOODWORK
STANDARDS-ED.1W.D.M.A.
SERIES I.S.1-A-2004
ASTM D5456-09
ANSI A208.1

NOTE: Dimensions are nominal before
trimming.

1. STILES: 7/16" (11 mm) wood (mill option) laminated
to 1" (25 mm) structural composite lumber (SCL)

2. TOP AND BOTTOM RAILS: 1-7/16" (37 mm)
structural composite lumber (SCL).

3. CORE: Particleboard core with a density of 28-32
PCF(449-513 kg/m³) LD-1, bonded to the stiles and
rails.

4. FACES: Hardboard.

8500-ME (5 PLY)

PARTICLE CORE, ULTRA HEAVY-DUTY,
ANTI-WARPING CONSTRUCTION FOR
INTENSIVE USE.

LOCK BLOCK: Integrated.

GLUE: Type 1 PVA Cross-link (NAUF).

INTERIOR USE

WARRANTY: LIFETIME

OPTIONS

20 minute fire rating, specify 8520-ME, 8520-ME
NAUF/FSC or 8520-ME-AF Wood veneer glued to
plywood veneer (3 ply plywood) (7ply door).
Autonomy door available, specify 8513-ME, 8513-ME
NAUF/FSC or 8513-ME-AF.

* To get M.R. 6.0, specify agrifibre core (8500-ME-AF).

** To get M.R. 7.0: Option 1: specify particleboard core
NAUF/FSC (8500-ME NAUF/FSC) and FSC faces to
optimize.

Option 2: specify agrifibre core (8500-ME-AF) and FSC
faces, only when M.R. 6.0 is also required.

*** To get I.E.Q. 4.4, specify particleboard core
NAUF/FSC (8500-ME NAUF/FSC) or agrifibre core
(8500-ME-AF) and NAUF or NAUF/FSC faces.

NOTE: Dimensions are nominal before
trimming.

1. STILES: 1/8" (3 mm) thick veneer, longitudinally
laminated by hot pressing with type 1 structural glue, as
per ASTM-D5456-93 (LVL FSC), including a 7/8" (22
mm) piece of hardwood, matched with faces, for a total
width of 4 3/16" (107 mm).

2. TOP AND BOTTOM RAILS: 1/8" (3 mm) thick veneer,
longitudinally laminated by hot pressing with type 1
structural glue, as per ASTM-D5456-93 (LVL FSC), or
laminated strand lumber (LSO for a total width of 3
5/16" (85 mm).

3. CORE: Solid particleboard. Density of 28-32 lbs per
cubic foot. Complies with CSA-0188 and ANSI A208-1
standards (LD-1/LD-2). Available AUF/FSC (LD-2).

4. FACES: Wood veneer (choice of face veneers; 2 ply
plywood), hardboard panel or plastic laminate glued to
composite crossband. Available NAUF/FSC.

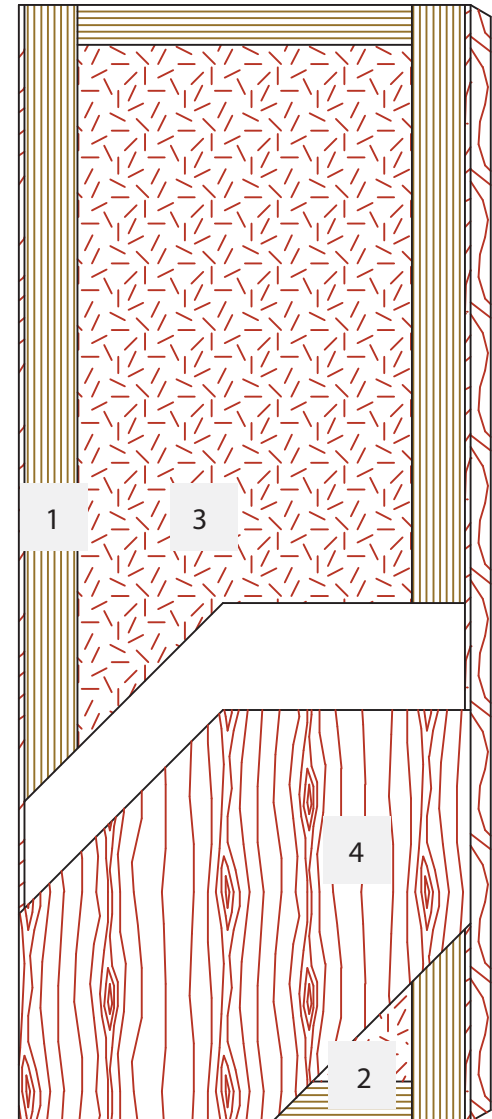

[inspired designs]











ZIPCLIK



Authorized Distributor:

Forest View Industries Ltd.

Toll Free: 1-888-293-5913

www.Zip-Clik.com

ZCMK-00620